

# LPA7-TRI-FL/2458

# COBHAM

## Directional Antenna

The most important thing we build is trust

### Key Features

Designed for DAS Applications

Tri-Band Cellular Antenna

Low Profile

Integrated Cable Options

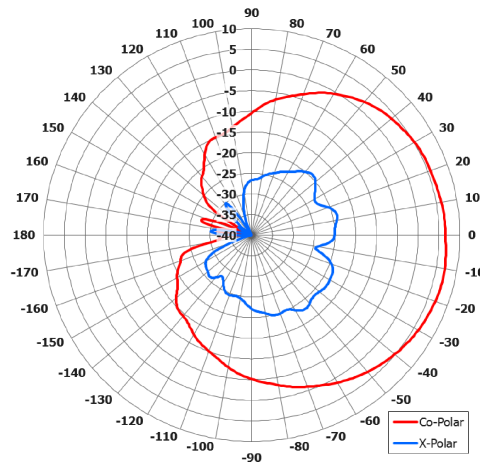

Azimuth Polar Plot

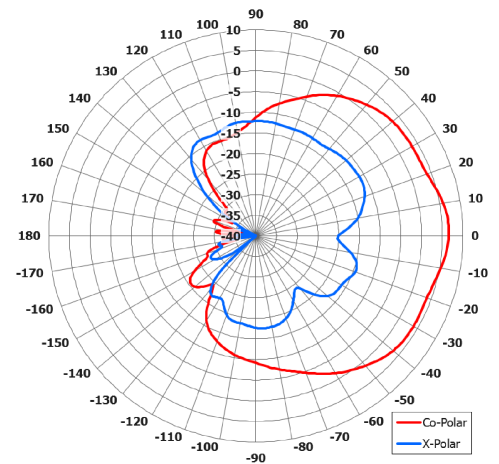

Elevation Polar Plot

### SIDE VIEW

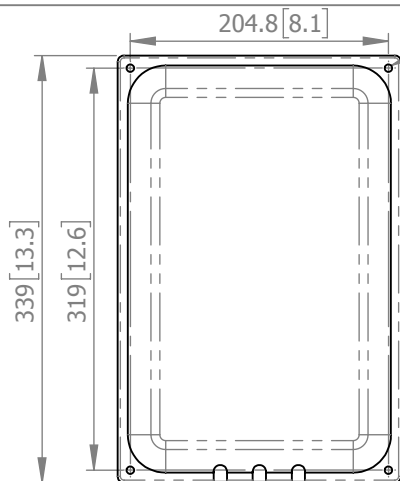

SUPPLIED WITH 4 OFF No.7 MOUNTING SCREWS AND WHITE SNAP CAPS

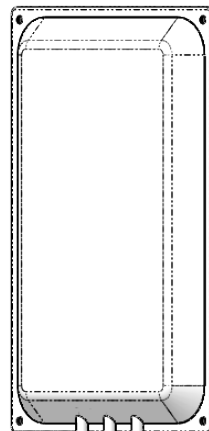

INTEGRAL CABLES WITH WHITE, LOW SMOKE, ZERO HALOGEN JACKETS, 1.0M LONG WITH SMA(M) CONNECTORS

### BASE VIEW

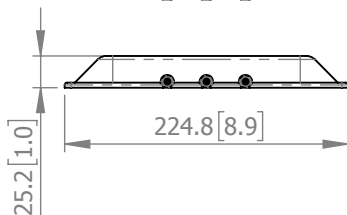

PORTS COLOUR CODED AS FOLLOWS:  
BLUE - 900 MHz  
RED - 1800MHz  
GREEN - 2000MHz

### ELECTRICAL

Frequency: 880 - 960 MHz

1710 - 1880 MHz

1920 - 2175 MHz

Gain: 7 dBi Nom.

Polarisation: Linear (Vertical)

Beamwidth: 80° (Az) x 80° (El)

Cross Polar: 15 dB Typ.

VSWR: 2:1 Max

Power Rating: 10 W

Front to Back: 20 dB Typ.

### MECHANICAL

Standard Finish: White Radome/ Aluminium Baseplate

Mass: 0.9 Kg / 2.0 lbs

Temperature: -20° to +50°C

Wind Loading: 12.3 Kg / 27.2 lbs @ 100 mph

### MOUNTING OPTIONS

Kits Available: N/A

See Separate Data Sheets

DS: 2458-2 Issued: 141118

Dimensions: mm [inches] L

Chelton Limited trading as Cobham Antenna Systems, Microwave Antennas

Chelton Limited has a policy of continuous development and stress that the information provided is a guide only and does not constitute an offer or contract or part thereof. Whilst every effort is made to ensure the accuracy of the information contained in this Data Sheet, no responsibility can be accepted for any errors or omissions.

The copyright of antenna designs and images is copyright protected and owned by Chelton Limited.  
©Chelton Limited.

For further information please contact:

Cobham Antenna Systems, Microwave Antennas, Lambda House, Cheveley, Newmarket, Suffolk, CB8 9RG, UK

T: +44 (0) 1638 732177

E: [newmarket.sales@cobham.com](mailto:newmarket.sales@cobham.com)

W: [www.cobham.com/antennasystems/microwaveantennas](http://www.cobham.com/antennasystems/microwaveantennas)